

SHEAR WALL SCHEDULE			
SYMBOL	SHEATHING/ ATTACHMENT (SEE NOTE 9)	SILL PL & SILL ATTACHMENT TO FOUNDATION	NOTES
1	7/16" SHEATHING W/ 8d @ 6" O.C. EDGES, 12" O.C. FIELD ALL EDGES BLOCKED	2x P.T. SILL PL W/ 5/8" @ 10" A.B.'S @ 48" O.C. W/ PLATE WASHERS PER NOTE 11	-SILL PLATE- -RIM TO RIM- 16d @ 6" O.C. -RIM TO PLATE- SIMPSON A35 CLIPS @ 32" O.C.

SHEAR WALL NOTES

- INDICATES EXTENT OF SHEAR WALL. PROVIDE HOLD-DOWNS AS CALLED OUT ON PLANS @ EACH END OF SHEAR WALL. HOLD-DOWNS INDICATE ON PLANS ARE BY "SIMPSON STRONG-TIE CO." INSTALL AS PER MANUF. RECOMMENDATIONS.
- IF A.B. SPACING IS GREATER THAN SHEAR WALL, PLACE (1) A.B. WITHIN 12" OF EACH END, UNLESS NOTED OTHERWISE.
- THE CAPACITY VALUES ARE APPLICABLE TO STUDS OF SPECIES GROUP II (DOUGLAS FIR-SOUTHERN PINE).
- PANEL EDGES SHALL BE BACKED WITH 2x NOMINAL (MIN.).
- ALL SHEATHING NAILS REFERENCED ARE COMMON WIRE NAILS (i.e. 8d @ 0.131") SOLE PLATE NAILS REFERENCED ARE TO BE SINKER NAILS (i.e. 16d @ 0.148"). VALUES OF THEIR STANDARD CONSTRUCTION FASTENERS WILL REQUIRE SPACING ADJUSTMENTS AND MUST BE APPROVED BY WISE PRIOR TO USE. MINIMUM NAIL PENETRATIONS INTO SUPPORT FRAMING: 8d-1.5", 10d-2.625", 16d-1.625".
- DO NOT PENETRATE SURFACE PLY OF SHEATHING WITH NAIL HEAD.
- APA RATED WALL SHEATHING C-D, C-C SHEATHING, PLYWOOD PANEL SIDING, OSB, AND OTHER GRADES COVERED IN 2014 OCSCH. 35 STANDARDS.
- SHEATHING FACE GRAIN CAN BE APPLIED PERPENDICULAR OR PARALLEL TO STUDS PROVIDED THE STUDS ARE SPACED @ 16" O.C. OR LESS, WHERE STUDS ARE SPACED GREATER THAN 16" O.C. APPLY SHEATHING PERPENDICULAR TO STUDS.
- SHEATHING MAY BE APPLIED AT EITHER SIDE OF WALL UNLESS REQ'D AT BOTH SIDES.
- WALL SHEATHING MUST BE EDGE NAILED @ STUDS ATTACHED TO HOLD-DOWNS, FULL HT.
- PER ANS/AF&PA SDPWS-08, SECTION 4.3.6.4.3. PROVIDE SIMPSON BPS-6 SLOTTED PLATE WASHERS (OR FABRICATED EQUIVALENT) WITH STANDARD CUT WASHERS BETWEEN PLATE WASHER & NUT. EDGE OF PLATE WASHER SHALL BE WITHIN 1/2" OF EDGE OF SILL PLATE ON THE SIDE WITH SHEATHING (WHERE SHEATHING IS REQUIRED @ BOTH SIDES, ALTERNATE SIDES.)
- FOUNDATION VENTS ARE ACCEPTABLE UNDER SHEAR WALLS. ANCHOR BOLTS SHALL BE PLACED 3" CLEAR OF FOUNDATION VENTS. ANY TWO ADJACENT VENTS MUST HAVE AT LEAST 12" OF CONCRETE BETWEEN. ANCHOR BOLT SPACING MAY VARY, BUT SCHEDULED AVERAGE SPACING MUST BE MAINTAINED.
- ALL HOLD-DOWN ANCHOR BOLTS SHOWN ON THE FOUNDATION PLAN REPRESENT A GENERAL LOCATION AND MUST BE VERIFIED BASED ON SPECIFIED POST SIZE WITH RELATION TO THE ROUGH OPENING/EDGE OF WALL LOCATIONS. REFERENCE ARCHITECTURAL DRAWINGS FOR DIMENSIONAL VERIFICATION.

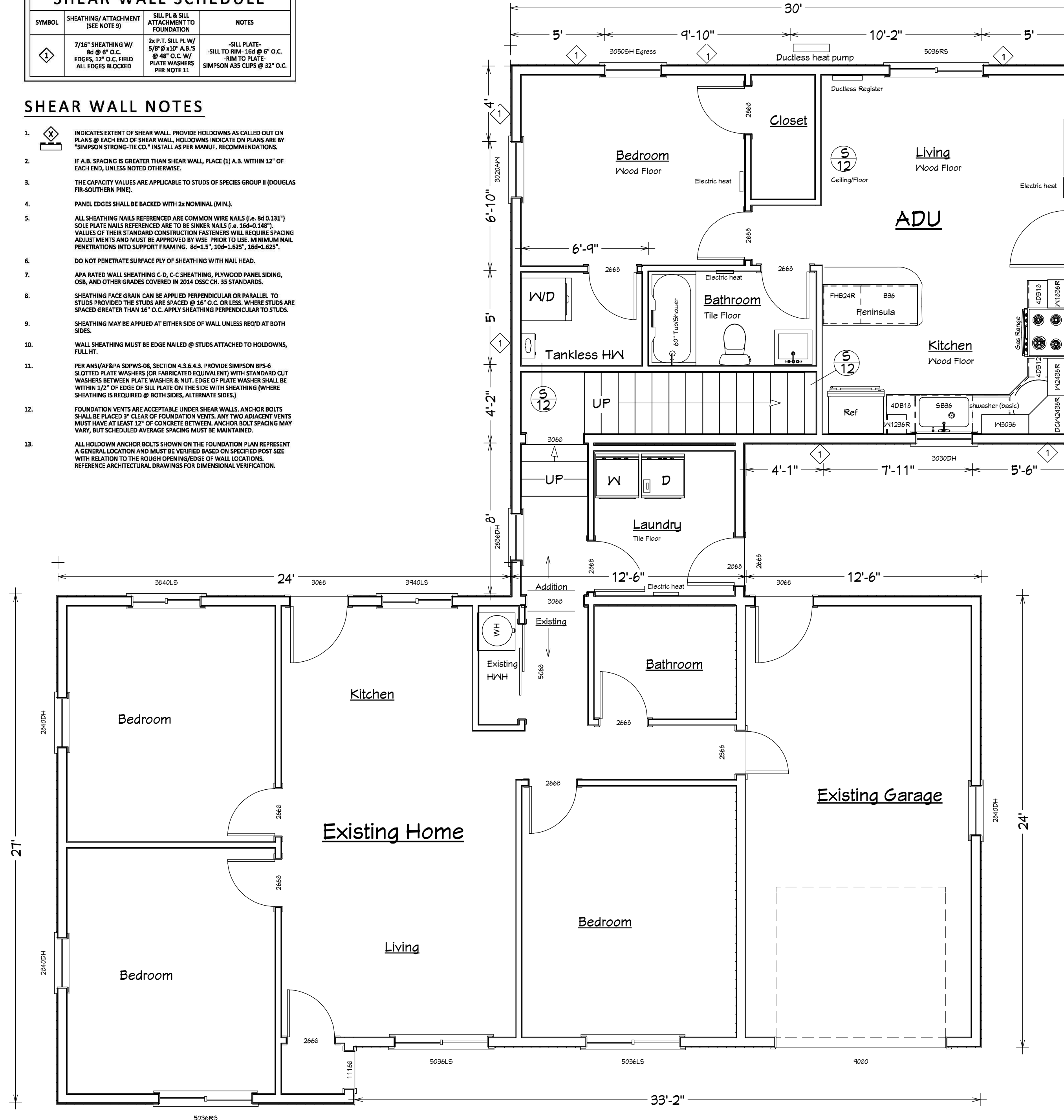

HDU2 Holddowns on 2-2x4 studs with SSTB16 anchors

Note
See S.12 sectional for 1 hour wall, floor/ceiling assembly details for dwelling separation as identified S/12 on plan.

First Floor Plan Addition 700 sq. ft
Scale: 1/4" = 1'-0" Existing 948 sq. ft.
ADU 600 sq.ft.

NO.	DESCRIPTION	BY	DATE

1st Floor Plan			
----------------	--	--	--

155 SW McKay Ave
Bend, OR 97702

Popp Home Building, LLC
PO Box 2222, Bend, OR
541-408-0434

DATE:
12-14-16

SCALE:
1/4" = 1'-0"

SHEET:
A.2